

SANI-LAV[®] COLUMBIA PRODUCTS

Valves



Model 101S, 101L



Model 102S, 102L



Model 103S, 103L



Model 104S, 104L



Model 105S, 105L



Model 106S, 106L



Model 111S, 111L



Model 109S, 109L

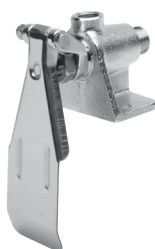

Model 110S, 110L



Model 112S, 112L



Model 201L



Model 1006L



Model 1007L



Model 1008L



■ Double Valve Plan View

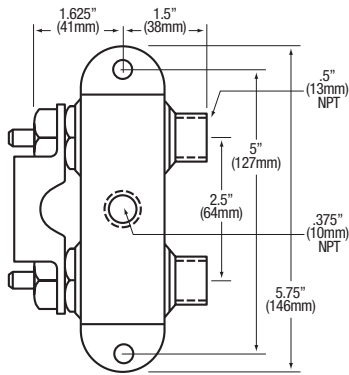

■ Double Valve Side View

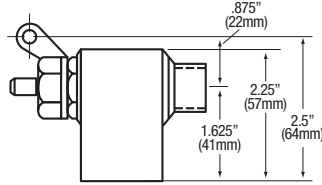

■ Single Valve Plan View

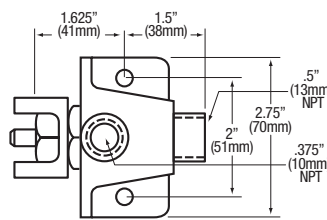

■ Single Valve Side View

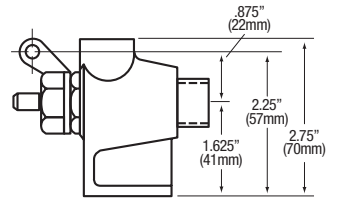

■ Knee Pedal Side View

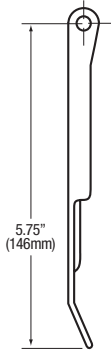

■ Extended Pedal Side View

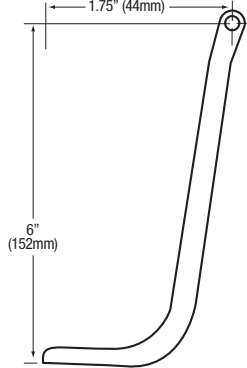

■ Short Pedal Side View

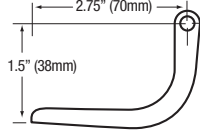

All Pedals 2" Wide

■ Model 201L Front View

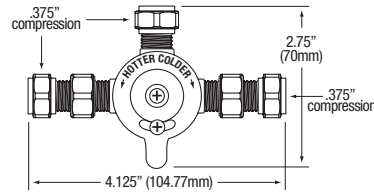

■ Model 1008L

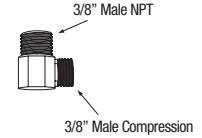

■ Model 1006L

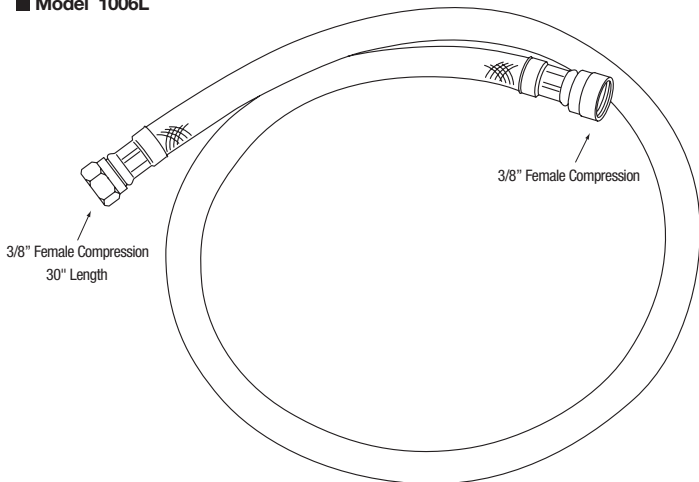

■ Model 1007L

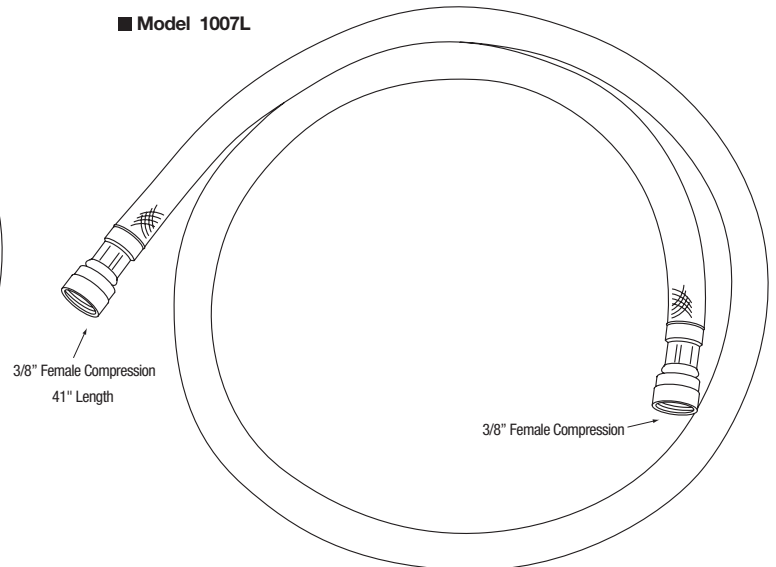

Notice for California Consumers
WARNING: This product can expose you to chemicals including Chromium (hexavalent compounds), Lead, and Phthalates (DEHP) which are known to the State of California to cause cancer and birth defects or other reproductive harm. For more information go to www.P65Warnings.ca.gov.

NOTE: Lead content originates from Brass components in valves and faucets and is certified under NSF/ANSI 372 as containing less than 0.25% lead in wetted surfaces.

Replacement Parts

Part No.	Description	Application
A 1041	Pedal, Long Foot	103/104/105/106 (S) (L)
B 1042	Pedal, Short Foot	101/102 (S) (L)
C 1043	Pedal, Knee	109/110/111/112 (S) (L)
D 1049	Bolt & Nut Set (Stainless)	All Single Valves
E 1050	Jam Nut (Stainless)	All Valves
F 1051	Bolt & Nut Set (Stainless)	All Double Valves
G 1052	Bracket	All Double Valves
H 1053	Threaded Insert (Low Lead)	All Valves
I 1053S	Threaded Insert (Stainless)	All Valves
J 1054	Bracket	All Single Valves
K 1055	Plunger Assembly (Low Lead)	All Valves
L 1055S	Plunger Assembly (Stainless)	All Valves
M 1056	Spring (Stainless)	All Valves
N 1057	Body only, Double Valve (Low Lead)	All Double Valves
O 1058	Body only, Single Valve	All Single Valves
P 1061L	Replacement Kit (Low Lead)	All Valves
Q 1061S	Replacement Kit (Stainless)	All Valves

Double Knee or Foot Pedal

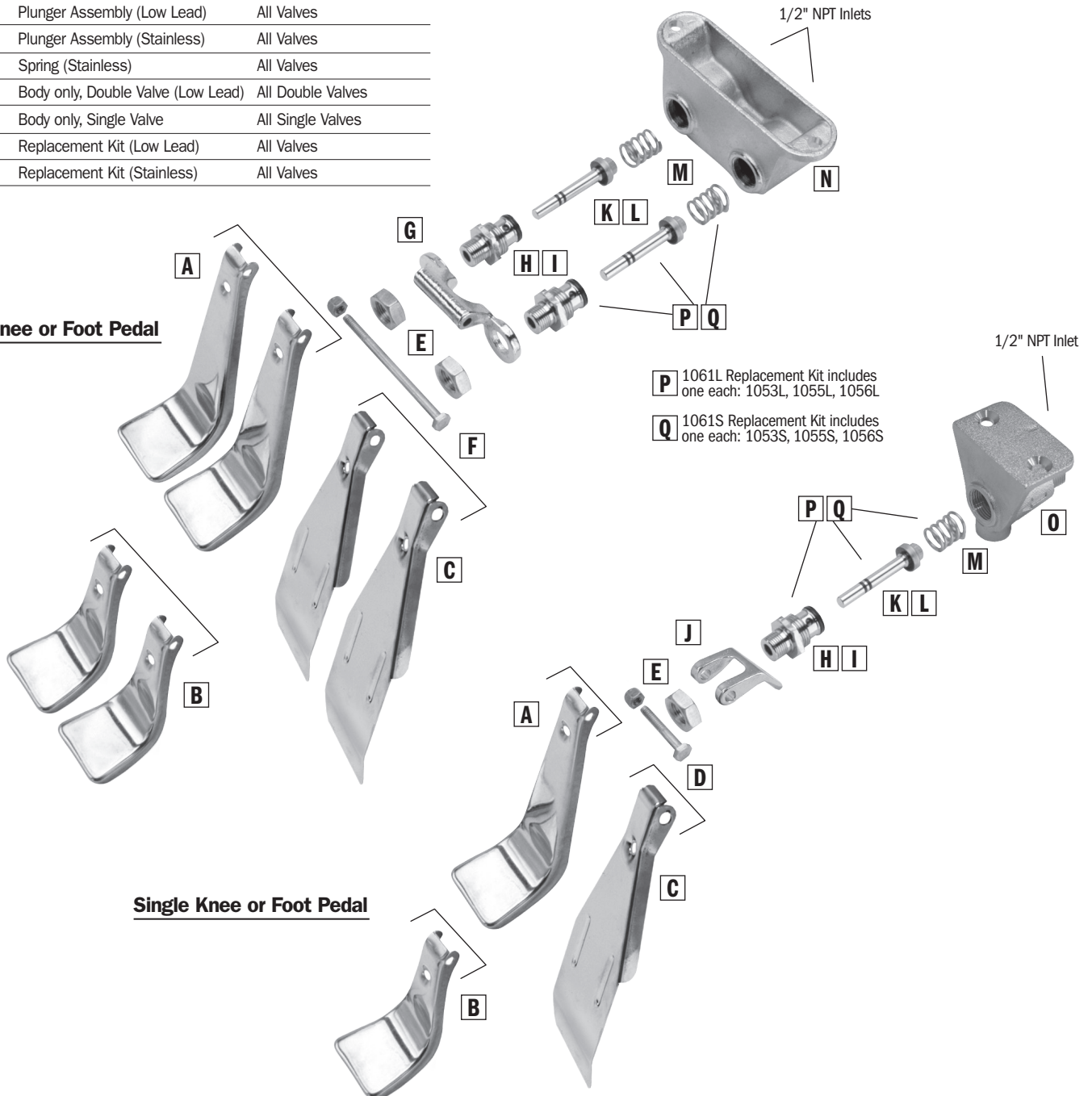

P 1061L Replacement Kit includes one each: 1053L, 1055L, 1056L

Q 1061S Replacement Kit includes one each: 1053S, 1055S, 1056S

Single Knee or Foot Pedal